

## AGENDA

### LICENSING SUB-COMMITTEE MEETING

Date: Thursday, 6 October 2022

Time: 10.00 am

Venue: Council Chamber - Swale House, East Street, Sittingbourne, Kent ME10 3HT\*

Membership:

Councillors Derek Carnell, Carole Jackson and Mike Whiting.

Quorum = 3

---

Pages

#### Information about this meeting

Members of the press and public can listen to this meeting live. Details of how to join the meeting will be added to the website on 5 October 2022.

#### Recording and Privacy Notice

Swale Borough Council is committed to protecting the security of your personal information. As data controller we process data in accordance with the Data Protection Act 2018 and the UK General Data Protection Regulation.

This meeting may be recorded. The recording will be retained in accordance with the Council's data retention policy and may be published on the Council's website. By entering the room and by speaking at a meeting, whether in person or online, you are consenting to being recorded and to the recording being published.

When joining a meeting online, your username will be visible to others in attendance. In joining the meeting you are consenting to us processing your username. You may use a pseudonym as your username but the use of an inappropriate name may lead to removal from the meeting.

If you have any questions about how we look after your personal information or your rights under the legislation, please email [dataprotectionofficer@swale.gov.uk](mailto:dataprotectionofficer@swale.gov.uk).

#### 1. Emergency Evacuation Procedure

Visitors and members of the public who are unfamiliar with the building and procedures are advised that:

- (a) The fire alarm is a continuous loud ringing. In the event that a fire drill is planned during the meeting, the Chair will advise of this.

- (b) Exit routes are signposted, one directly to a fire escape at the end of the corridor, the other to the stairs opposite the lifts.
  - (c) In the event of the alarm sounding, leave the building via the nearest safe exit and gather at the assembly point on the far side of the car park. Do not leave the assembly point or re-enter the building until advised to do so. Do not use the lifts.
  - (d) Anyone unable to use the stairs should make themselves known during this agenda item.
2. Apologies for Absence
  3. Notification of Chairman and Outline of Procedure
  4. Declarations of Interest

Councillors should not act or take decisions in order to gain financial or other material benefits for themselves, their families or friends.

The Chair will ask Members if they have any disclosable pecuniary interests (DPIs) or disclosable non-pecuniary interests (DNPis) to declare in respect of items on the agenda. Members with a DPI in an item must leave the room for that item and may not participate in the debate or vote.

Aside from disclosable interests, where a fair-minded and informed observer would think there was a real possibility that a Member might be biased or predetermined on an item, the Member should declare this and leave the room while that item is considered.

Members who are in any doubt about interests, bias or predetermination should contact the monitoring officer for advice prior to the meeting.

#### **Part B Report for the Licensing Sub-Committee to decide**

5. Application for a new Premises Licence

5 - 58

To consider a new premises licence for The Little Blue Hut, South Street, Queenborough.

#### **Issued on Tuesday, 27 September 2022**

The reports included in Part I of this agenda can be made available in **alternative formats**. For further information about this service, or to arrange for special facilities to be provided at the meeting, **please contact DEMOCRATIC SERVICES on 01795 417330**. To find out more about the work of this Committee, please visit [www.swale.gov.uk](http://www.swale.gov.uk)

**Chief Executive, Swale Borough Council,  
Swale House, East Street, Sittingbourne, Kent, ME10 3HT**

This page is intentionally left blank

<b>Licensing Sub-Committee</b>	
<b>Meeting Date</b>	6 <sup>th</sup> October 2022
<b>Report Title</b>	Consideration of an application for the grant of a new premises licence under the Licensing Act 2003
<b>Premises</b>	The Little Blue Hut, Queenborough Harbour, South Street, Queenborough, Kent ME11 5AF
<b>Lead Officer</b>	Christina Hills, Licensing Team Leader
<b>Classification</b>	<b>Open</b>
<b>Recommendations</b>	1. Members are requested to determine the application on its merits

## **1 Purpose of Report and Executive Summary**

- 1.1 The report advises Members of an application for a premises licence to be granted under the Licensing Act 2003 in respect of which representations have been made by eight (8) interested parties

## **2 Background**

- 2.1 The Licensing Sub-Committee is asked to determine an application for the grant of a new premises licence under the Licensing Act 2003 in respect of premises at The Little Blue Hut, Queenborough Harbour, South Street, Queenborough, Kent ME11 5AF
- 2.2 The Licensing Act 2003 (the 2003 Act) requires the Council (as licensing authority) to carry out its various functions so as to promote the following four licensing objectives:
- the prevention of crime and disorder
  - the protection of public safety
  - the prevention of public nuisance
  - the protection of children from harm
- 2.3 The 2003 Act requires the council to publish a 'Statement of Licensing Policy' that sets out the policies the council will generally apply to promote the licensing objectives when making decisions on applications made under the Act. The council first adopted its Statement of Licensing Policy in 2004 and it has been regularly reviewed in line with legislative requirements ever since. The latest

policy was adopted on 1 April 2021. The Policy will be available at the meeting for reference purposes.

- 2.4 Under the 2003 Act, licensing authorities must, in carrying out their functions, have regard to guidance issued by the Secretary of State under section 182. The Guidance cannot anticipate every possible scenario or set of circumstances that may arise. Provided that the licensing authority has properly understood and considered the Guidance, it may depart from it when it has reason to do so. However, as the licensing authority is under a duty to have regard to the Guidance, it will need to give full reasons for any departure from it. This would be a key consideration for the courts should departure from the Guidance result in a determination which gives right to an appeal or judicial review. The Guidance will be available at the meeting for reference purposes.
- 2.5 A copy of the council's approved procedure for hearings of the Licensing Sub-Committee in relation to an application, along with a copy of the Hearings Regulations has been circulated to all parties prior to the meeting.
- 2.6 The Licensing Authority must, under the Act, refer any application for hearing to the Licensing Sub-Committee where relevant representations are made by a responsible authority or an interested party.
- 2.7 The Licensing Sub-Committee is reminded that the Human Rights Act 1998 guarantees the right to a fair hearing for all parties in the determination of their civil rights. The Act also provides for the protection of property which may include licences in existence and the protection of private and family life.

### **3 The Application**

- 3.1 On 14<sup>th</sup> August 2022 an application was received from Ms Caroline Kennedy for the grant of a premises licence under section 17 of the Licensing Act 2003.
- 3.2 The application is for:  
Sale of Alcohol (on the premises)  
Friday – Sunday 10:00 – 20:00  
  
Also 10:00 – 20:00 on all bank and public holidays, Valentine's Day, Mother's Day, Father's Day, Christmas Eve and New Year's Eve and on days when Queenborough Market is operated on Queenborough Harbour
- 3.3 Part M of the statutory application form asks applicants to describe the steps they intend to take to promote the four licensing objectives. Where an application has been properly made and no responsible authority or other person has made a relevant representation, or where representations are made and subsequently withdrawn, these proposals are 'converted' in the form of clear and enforceable

licence conditions which, together with the Mandatory Conditions, make up the premises licence.

- 3.4 A copy of the application is shown as **Appendix I**. A copy of the plan for the premises are shown at **Appendix II**. Photos of the premises are shown as **Appendix III**.
- 3.5 Permission to use the premises for the sale of alcohol has been obtained from Queenborough Harbour Trust as shown at **Appendix IV**.

## **4 Representations**

4.1 At any stage during the 28 day consultation period a responsible authority, a Councillor or an interested party, may make representations provided that the grounds are relevant to the licensing objectives and are not deemed to be vexatious, frivolous or repetitive.

4.2 Representations from responsible authorities:

- Kent and Medway Fire and Rescue Service – No representations.
- Kent County Council Trading Standards – No representations
- Kent County Council Services Children and Families – No representations
- Kent County Council Public Health – No representations
- Environmental Health, Swale BC – No representations
- Swale Borough Council Planning Area Team – No representations
- Kent Police – Have requested conditions as shown below:
  1. All persons that sell or supply alcohol to customers must have licensing training
  2. Training should take place within six weeks of employment and any new employees will be supervised until the training has taken place
    - a) Refresher training should be repeated a minimum of every six months or earlier if required due to changes of legislation
    - b) Training records must be kept and shall contain the nature, content, and frequency of all training
    - c) Records must be made available for inspection by Police, Police Licensing Officer, and authorised officers from the Local Authority upon request either electronically or hard copy
  3. A challenge 25 proof of age scheme shall be operated at the premises where the only acceptable forms of identification are recognised photographic identification cards, such as driving licence, passport, military ID card or proof of age card with the PASS Hologram.

4. After close of business, staff will clear any rubbish that has been left within the licensable area of this premises licence.
- 4.3 There have been eight (8) representations from members of the public. The representations are made on the basis of all 4 of the licensing objectives of prevention of crime and disorder, promotion of public safety, prevention of public nuisance, and protection of children from harm. These are shown at **Appendix V**.

## **5 Policy considerations**

The following provisions of the Secretary of State's Guidance apply to this application:

Chapter 2 – The licensing objectives

Chapter 8 – Applications for premises licences

Chapter 9 – Determining applications

Chapter 10 – Conditions attached to Premises Licences

The following paragraphs of the Council's Statement of Licensing Policy apply to this application:

Sections 3.1 to 3.14.4 – These sections set out the Council's approach with regard to licensing and details other mechanisms to deal with potential problems.

Section 2.1 to 2.8 – These sections set out the four licensing objectives and identifies matters that may be relevant to the promotion of each licensing objective.

Section 8 relating to new premises licence applications

Section 17 relating to conditions



## 6 Determining the application – Options of the Sub-Committee

5.1 Members are asked to determine which of the following options they deem appropriate:

- (i) grant a licence as applied for
- (i) grant a licence subject to conditions consistent with the Operating Schedule modified to such an extent as considered appropriate for the promotion of the licensing objectives and any mandatory conditions
- (ii) grant a licence but excluding any of the licensable activities applied for
- (iii) grant a licence but refusing to specify a designated premises supervisor
- (iv) reject the application

5.2 Members of the Licensing Sub-Committee are reminded of their duty under Section 17 of the Crime and Disorder Act 1998 to consider the crime and disorder implications of their decisions and the Licensing Authority's responsibility to so-operate in the reduction of crime and disorder in the Borough.

## 6 Implications

Issue	Implications
Corporate Plan	There are direct links to Priority 3 – 3.4 Ensure that the council plays a proactive role in reducing crime and antisocial behaviour.....
Financial, Resource and Property	None unless there is an appeal to Magistrates' Court which proves to be successful and which could therefore result in costs being awarded against the Council.
Legal and Statutory	<p>The Licensing Sub-Committee must carry out its functions with a view to promoting the four licensing objectives.</p> <p>The procedure for dealing with new premises licence applications is set out in the Licensing Act 2003.</p> <p>Schedule 5 of the Licensing Act 2003 deals with appeals. Any party to the application has the right to appeal the decision of the Licensing Sub Committee. Such appeal must be made to a Magistrates' Court within 21 days of the Appellant being notified of the decision.</p>

Crime and Disorder	The council has a duty under section 17 of the Crime and Disorder Act 1998 to consider the crime and disorder implications of their decisions and the Licensing Authority's responsibility to co-operate in the reduction of crime and disorder in the Borough. Section 17 of the Crime and Disorder Act 1998 states "Without prejudice to any other obligation imposed on it, it shall be the duty of each authority to which this section applies to exercise its various functions with due regard to the likely effect of the exercise of those functions on, and the need to do all that it reasonably can to prevent crime and disorder in its area"
Environmental Sustainability	No implications
Health and Wellbeing	No implications
Safeguarding of Children, Young People and Vulnerable Adults	Premises Licence Holders must be 'fit and proper' to operate licensed premises responsibly and uphold the licensing objectives which include 'protection of children from harm'
Risk Management and Health and Safety	Departure from the Guidance and Statement of Licensing Policy could lead to an increased risk of appeal. Similarly, if any decision made is not evidence based and proportionate
Equality and Diversity	No implications
Privacy and Data Protection	Normal privacy and data protection rules apply.

## 6 Appendices

6.1 The following documents are to be published with this report and form part of the report:

- **Appendix I:** Application form
- **Appendix II:** Plan of premises
- **Appendix III:** Photos of premises
- **Appendix IV:** Letter of permission from Queenborough Harbour Trust
- **Appendix V:** Representations from interested parties about the application

## 7 Background Papers

The Licensing Act 2003  
Guidance issued under Section 182 of the Licensing Act 2003 (as amended)  
Swale BC Statement of Licensing Policy



This page is intentionally left blank

## Application for a premises licence to be granted under the Licensing Act 2003

### Please read the following instructions first

Before completing this form please read the guidance notes at the end of the form. If you are completing this form by hand please write legibly in block capitals. In all cases ensure that your answers are inside the boxes and written in black ink. Use additional sheets if necessary.

You may wish to keep a copy of the completed form for your records.

### I/We **Caroline Kennedy**

*(Insert name(s) of applicant)*

apply for a premises licence under section 17 of the Licensing Act 2003 for the premises described in Part 1 below (the premises) and I/we are making this application to you as the relevant licensing authority in accordance with section 12 of the Licensing Act 2003

### Part 1 – Premises details

Postal address of premises or, if none, ordnance survey map reference or description			
<b>The Little Blue Hut                  South Street                  Quayside                  Queenborough</b>			
<b>Post town</b>	<b>Sheerness</b>	<b>Postcode</b>	<b>ME11 5AG</b>

Telephone number at premises (if any)	<b>0747678876</b>
Non-domestic rateable value of premises	<b>£ 0</b>

### Part 2 - Applicant details

Please state whether you are applying for a premises licence as **appropriate** **Please tick as**

a)	an individual or individuals *	<input checked="" type="checkbox"/>	please complete section (A)
b)	a person other than an individual *	<input type="checkbox"/>	
	i as a limited company/limited liability partnership	<input type="checkbox"/>	please complete section (B)
	ii as a partnership (other than limited liability)	<input type="checkbox"/>	please complete section (B)
	iii as an unincorporated association or	<input type="checkbox"/>	please complete section (B)
	iv other (for example a statutory corporation)	<input type="checkbox"/>	please complete section (B)

c)	a recognised club		please complete section (B)
d)	a charity		please complete section (B)
e)	the proprietor of an educational establishment		please complete section (B)
f)	a health service body		please complete section (B)
g)	a person who is registered under Part 2 of the Care Standards Act 2000 (c14) in respect of an independent hospital in Wales		please complete section (B)
ga)	a person who is registered under Chapter 2 of Part 1 of the Health and Social Care Act 2008 (within the meaning of that Part) in an independent hospital in England		please complete section (B)
h)	the chief officer of police of a police force in England and Wales		please complete section (B)

\* If you are applying as a person described in (a) or (b) please confirm (by ticking yes to one box below):

- I am carrying on or proposing to carry on a business which involves the use of the premises for licensable activities; or
- I am making the application pursuant to a
- statutory function or
- a function discharged by virtue of Her Majesty's prerogative

**(A) individual applicants** (fill in as applicable)

Mr	Mrs	Miss √	Ms	Other Title (for example, Rev)	
<b>Surname Kennedy</b>			<b>First name Caroline</b>		
<b>Date of birth</b>		I am 18 years old or over		Please tick yes √	
<b>Nationality</b>		<b>British</b>			
Current residential address if different from premises address					
Post town				Postcode	
<b>Daytime contact telephone number</b>					
<b>E-mail address (optional)</b>					
Where applicable (if demonstrating a right to work via the Home Office online right to work checking service), the 'share code' provided to the applicant by that service (please see note 15 for information)					

--

**Second individual applicant** (if applicable)

Mr	Mrs	Miss	Ms	Other Title (for example, Rev)	
<b>Surname</b>			<b>First names</b>		
<b>Date of birth</b> or over		I am 18 years old		Please tick yes	
<b>Nationality</b>					
Current residential address if different from premises address					
Post town				Postcode	
<b>Daytime contact telephone number</b>					
<b>E-mail address (optional)</b>					
Where applicable (if demonstrating a right to work via the Home Office online right to work checking service), the 'share code' provided to the applicant by that service: (please see note 15 for information)					

**(B) Other applicants**

**Please provide name and registered address of applicant in full. Where appropriate please give any registered number. In the case of a partnership or other joint venture (other than a body corporate), please give the name and address of each party concerned.**

Name
Address

Registered number (where applicable)
Description of applicant (for example, partnership, company, unincorporated association etc.)
Telephone number (if any)
E-mail address (optional)

**Part 3 Operating Schedule**

When do you want the premises licence to start?

DD	MM	YYYY
<input type="text"/>	<input type="text"/>	<input type="text"/>

If you wish the licence to be valid only for a limited period, when do you want it to end?

DD	MM	YYYY
<input type="text"/>	<input type="text"/>	<input type="text"/>

<p>Please give a general description of the premises (please read guidance note 1)</p> <p>Purpose built hut measuring approx. 8m<sup>2</sup> with small seating area on the quayside</p>
--

If 5,000 or more people are expected to attend the premises at any one time, please state the number expected to attend.

What licensable activities do you intend to carry on from the premises?

(please see sections 1 and 14 and Schedules 1 and 2 to the Licensing Act 2003)

Provision of regulated entertainment (please read guidance note 2)	Please tick all that apply
a) plays (if ticking yes, fill in box A)	<input type="checkbox"/>
b) films (if ticking yes, fill in box B)	<input type="checkbox"/>
c) indoor sporting events (if ticking yes, fill in box C)	<input type="checkbox"/>
d) boxing or wrestling entertainment (if ticking yes, fill in box D)	<input type="checkbox"/>



e)	live music (if ticking yes, fill in box E)	
f)	recorded music (if ticking yes, fill in box F)	
g)	performances of dance (if ticking yes, fill in box G)	
h)	anything of a similar description to that falling within (e), (f) or (g) (if ticking yes, fill in box H)	

<b><u>Provision of late night refreshment</u></b> (if ticking yes, fill in box I)	
<b><u>Supply of alcohol</u></b> (if ticking yes, fill in box J)	

**In all cases complete boxes K, L and M**

**A**

<b>Plays</b> Standard days and timings (please read guidance note 7)			<b><u>Will the performance of a play take place indoors or outdoors or both – please tick</u></b> (please read guidance note 3)	Indoors	
				Outdoors	
Day	Start	Finish		Both	
Mon			<b><u>Please give further details here</u></b> (please read guidance note 4)		
Tue					
Wed			<b><u>State any seasonal variations for performing plays</u></b> (please read guidance note 5)		
Thur					
Fri			<b><u>Non standard timings. Where you intend to use the premises for the performance of plays at different times to those listed in the column on the left, please list</u></b> (please read guidance note 6)		
Sat					
Sun					

**B**

Films Standard days and timings (please read guidance note 7)			Will the exhibition of films take place <u>indoors or outdoors or both – please tick</u> (please read guidance note 3)	Indoors	
Day	Start	Finish		Outdoors	
Mon				<b><u>Please give further details here</u></b> (please read guidance note 4)	
Tue					
Wed			<b><u>State any seasonal variations for the exhibition of films</u></b> (please read guidance note 5)		
Thur					
Fri			<b><u>Non standard timings. Where you intend to use the premises for the exhibition of films at different times to those listed in the column on the left, please list</u></b> (please read guidance note 6)		
Sat					
Sun					

**C**

<b>Indoor sporting events</b> Standard days and timings (please read guidance note 7)			<b><u>Please give further details</u></b> (please read guidance note 4)
Day	Start	Finish	
Mon			
Tue			<b><u>State any seasonal variations for indoor sporting events</u></b> (please read guidance note 5)
Wed			
Thur			<b><u>Non standard timings. Where you intend to use the premises for indoor sporting events at different times to those listed in the column on the left, please list</u></b> (please read guidance note 6)
Fri			
Sat			
Sun			

**D**

<b>Boxing or wrestling entertainments</b> Standard days and timings (please read guidance note 7)			<b>Will the boxing or wrestling entertainment take place indoors or outdoors or both – please tick</b> (please read guidance note 3)	Indoors	
Day	Start	Finish		Outdoors	
Mon				Both	
			<b><u>Please give further details here</u></b> (please read guidance note 4)		
			<b><u>State any seasonal variations for boxing or wrestling entertainment</u></b> (please read guidance note 5)		
			<b><u>Non standard timings. Where you intend to use the premises for boxing or wrestling entertainment at different times to those listed in the column on the left, please list</u></b> (please read guidance note 6)		

**E**

<b>Live music</b> Standard days and timings (please read guidance note 7)			<b>Will the performance of live music take place indoors or outdoors or both – please tick</b> (please read guidance note 3)	Indoors	
Day	Start	Finish		Outdoors	
				Both	
Mon			<b>Please give further details here</b> (please read guidance note 4)		
Tue					
Wed			<b>State any seasonal variations for the performance of live music</b> (please read guidance note 5)		
Thur					
Fri			<b>Non standard timings. Where you intend to use the premises for the performance of live music at different times to those listed in the column on the left, please list</b> (please read guidance note 6)		
Sat					
Sun					

**F**

<b>Recorded music</b> Standard days and timings (please read guidance note 7)			<b>Will the playing of recorded music take place indoors or outdoors or both – please tick</b> (please read guidance note 3)	Indoors	
Day	Start	Finis h		Outdoors	
Mon				Both	
			<b>Please give further details here</b> (please read guidance note 4)		
			<b>State any seasonal variations for the playing of recorded music</b> (please read guidance note 5)		
			<b>Non standard timings. Where you intend to use the premises for the playing of recorded music at different times to those listed in the column on the left, please list</b> (please read guidance note 6)		

**G**

<b>Performances of dance</b> Standard days and timings (please read guidance note 7)			<b><u>Will the performance of dance take place indoors or outdoors or both – please tick</u></b> (please read guidance note 3)	Indoors	
Day	Start	Finish		Outdoors	
Mon				<b><u>Please give further details here</u></b> (please read guidance note 4)	Both
Tue					
Wed			<b><u>State any seasonal variations for the performance of dance</u></b> (please read guidance note 5)		
Thur					
Fri			<b><u>Non standard timings. Where you intend to use the premises for the performance of dance at different times to those listed in the column on the left, please list</u></b> (please read guidance note 6)		
Sat					
Sun					



# H

<b>Anything of a similar description to that falling within (e), (f) or (g)</b> Standard days and timings (please read guidance note 7)			Please give a description of the type of entertainment you will be providing		
Day	Start	Finish	<b><u>Will this entertainment take place indoors or outdoors or both – please tick</u></b> (please read guidance note 3)	Indoors	
Mon				Outdoors	
				Both	
Tue			<b><u>Please give further details here</u></b> (please read guidance note 4)		
Wed					
Thur			<b><u>State any seasonal variations for entertainment of a similar description to that falling within (e), (f) or (g)</u></b> (please read guidance note 5)		
Fri					
Sat			<b><u>Non standard timings. Where you intend to use the premises for the entertainment of a similar description to that falling within (e), (f) or (g) at different times to those listed in the column on the left, please list</u></b> (please read guidance note 6)		
Sun					

I

<b>Late night refreshment</b> Standard days and timings (please read guidance note 7)			<b>Will the provision of late night refreshment take place indoors or outdoors or both – please tick</b> (please read guidance note 3)	Indoors	
				Outdoors	
Day	Start	Finish		Both	
Mon			<b><u>Please give further details here</u></b> (please read guidance note 4)		
Tue					
Wed			<b><u>State any seasonal variations for the provision of late night refreshment</u></b> (please read guidance note 5)		
Thur					
Fri			<b><u>Non standard timings. Where you intend to use the premises for the provision of late night refreshment at different times, to those listed in the column on the left, please list</u></b> (please read guidance note 6)		
Sat					
Sun					

**J**

<b>Supply of alcohol</b> Standard days and timings (please read guidance note 7)			<b>Will the supply of alcohol be for consumption – please tick</b> (please read guidance note 8)	On the premises	x
				Off the premises	
Day	Start	Finish		Both	
Mon			<b>State any seasonal variations for the supply of alcohol</b> (please read guidance note 5)		
Tue					
Wed					
Thur			<b>Non standard timings. Where you intend to use the premises for the supply of alcohol at different times to those listed in the column on the left, please list</b> (please read guidance note 6)  10:00 – 20:00 on all bank holidays and public holidays, Valentine’s Day, Mother’s Day, Father’s Day, Christmas Eve and New Year’s Eve  10:00 – 20:00 on days when Queenborough Market is operated on Queenborough Harbour		
Fri	10:00	20:00			
Sat	10:00	20:00			
Sun	10:00	20:00			

**State the name and details of the individual whom you wish to specify on the licence as designated premises supervisor (Please see declaration about the entitlement to work in the checklist at the end of the form):**

<b>Name</b>	Caroline Kennedy
<b>Date of birth</b>	
<b>Address</b>	
<b>Postcode</b>	
<b>Personal licence number (if known)</b>	
<b>Issuing licensing authority (if known)</b>	



--	--	--	--

## M

Describe the steps you intend to take to promote the four licensing objectives:

**a) General – all four licensing objectives (b, c, d and e)** (please read guidance note 10)

This is a small scale operation with the aim to enhance the ambience of Queenborough Harbour not to detract from it. We will have a limited amount of seating which is currently 3 benches and we do not intend to have much more. We may play music probably no more than a couple of times a year as part of community days such as Queenborough Independence Day.

The site plan which accompanies this application details the licensable area to be used on a day to day basis with a yellow outline. The red outline for the whole of the harbour is to allow for any market trader on Queenborough Harbour Market day to trade under the auspices of this licence if we are happy for them to do so

It is not our intention to disturb nearby residents in any way and we will be happy to work with the local community should issues arise that they believe are to do with how this small hut will operate

**b) The prevention of crime and disorder**

CCTV is in place for the harbour

**c) Public safety**

All alcohol to be served in plastic glasses  
Chain link fence to prevent people falling into the harbour

**d) The prevention of public nuisance**

Maximum opening time is 20:00. In practice the closing time is usually 16:00

**e) The protection of children from harm**

All staff trained in Challenge 25  
 Staff to judge whether to serve alcohol to adults accompanied by children

**Checklist:**

**Please tick to indicate agreement**

•	I have made or enclosed payment of the fee.	
•	I have enclosed the plan of the premises.	
•	I have sent copies of this application and the plan to responsible authorities and others where applicable.	
•	I have enclosed the consent form completed by the individual I wish to be designated premises supervisor, if applicable.	
•	I understand that I must now advertise my application.	
•	I understand that if I do not comply with the above requirements my application will be rejected.	
•	[Applicable to all individual applicants, including those in a partnership which is not a limited liability partnership, but not companies or limited liability partnerships] I have included documents demonstrating my entitlement to work in the United Kingdom or my share code issued by the Home Office online right to work checking service (please read note 15).	

It is an offence, under Section 158 of the Licensing Act 2003, to make a false statement in or in connection with this application. Those who make a false statement may be liable on summary conviction to a fine of any amount.

It is an offence under Section 24b of the Immigration Act 1971 for a person to work when they know, or have reasonable cause to believe, that they are disqualified from doing so by reason of their immigration status. Those who employ an adult without leave or who is subject to conditions as to employment will be liable to a civil penalty under section 15 of the Immigration, Asylum and Nationality Act 2006 and pursuant to Section 21 of the same act, will be committing an offence where they do so in the knowledge, or with reasonable cause to believe, that the employee is disqualified.

**Part 4 – Signatures** (please read guidance note 11)

**Signature of applicant or applicant’s solicitor or other duly authorised agent** (see guidance note 12). **If signing on behalf of the applicant, please state in what capacity.**

<b>Declaration</b>	<ul style="list-style-type: none"> <li>[Applicable to individual applicants only, including those in a partnership which is not a limited liability partnership] I understand I am not entitled to be issued with a licence if I do not have the entitlement to live and work in the UK (or if I am subject to a condition preventing me from doing work relating</li> </ul>
--------------------	--

	<p>to the carrying on of a licensable activity) and that my licence will become invalid if I cease to be entitled to live and work in the UK (please read guidance note 15).</p> <ul style="list-style-type: none"> <li>The DPS named in this application form is entitled to work in the UK (and is not subject to conditions preventing him or her from doing work relating to a licensable activity) and I have seen a copy of his or her proof of entitlement to work, or have conducted an online right to work check using the Home Office online right to work checking service which confirmed their right to work (please see note 15)</li> </ul>
Signature	
Date	14/08/2022
Capacity	Proposed premises licence holder and DPS

**For joint applications, signature of 2<sup>nd</sup> applicant or 2<sup>nd</sup> applicant's solicitor or other authorised agent** (please read guidance note 13). **If signing on behalf of the applicant, please state in what capacity.**

Signature	
Date	
Capacity	

Contact name (where not previously given) and postal address for correspondence associated with this application (please read guidance note 14)			
Post town		Postcode	
Telephone number (if any)			
If you would prefer us to correspond with you by e-mail, your e-mail address (optional)			

## Notes for Guidance

1. Describe the premises, for example the type of premises, its general situation and layout and any other information which could be relevant to the licensing objectives. Where your application includes off-supplies of alcohol and you intend to provide a place for consumption of these off-supplies, you must include a description of where the place will be and its proximity to the premises.
2. In terms of specific regulated entertainments please note that:
  - Plays: no licence is required for performances between 08:00 and 23.00 on any day, provided that the audience does not exceed 500.
  - Films: no licence is required for 'not-for-profit' film exhibition held in community premises between 08.00 and 23.00 on any day provided that the audience does not exceed 500 and the organiser (a) gets consent to the screening from a person who is responsible for the premises; and (b) ensures that each such screening abides by age classification ratings.
  - Indoor sporting events: no licence is required for performances between 08.00 and 23.00 on any day, provided that the audience does not exceed 1000.
  - Boxing or Wrestling Entertainment: no licence is required for a contest, exhibition or display of Greco-Roman wrestling, or freestyle wrestling between 08.00 and 23.00 on any day, provided that the audience does not exceed 1000. Combined fighting sports – defined as a contest, exhibition or display which combines boxing or wrestling with one or more martial arts – are licensable as a boxing or wrestling entertainment rather than an indoor sporting event.
  - Live music: no licence permission is required for:
    - a performance of unamplified live music between 08.00 and 23.00 on any day, on any premises.
    - a performance of amplified live music between 08.00 and 23.00 on any day on premises authorised to sell alcohol for consumption on those premises, provided that the audience does not exceed 500.
    - a performance of amplified live music between 08.00 and 23.00 on any day, in a workplace that is not licensed to sell alcohol on those premises, provided that the audience does not exceed 500.
    - a performance of amplified live music between 08.00 and 23.00 on any day, in a church hall, village hall, community hall, or other similar community premises, that is not licensed by a premises licence to sell alcohol, provided that (a) the audience does not exceed 500, and (b) the organiser gets consent for the performance from a person who is responsible for the premises.
    - a performance of amplified live music between 08.00 and 23.00 on any day, at the non-residential premises of (i) a local authority, or (ii) a school, or (iii) a hospital, provided that (a) the audience does not exceed 500, and (b) the organiser gets consent for the performance on the relevant premises from: (i) the local authority concerned, or (ii) the school or (iii) the health care provider for the hospital.
  - Recorded Music: no licence permission is required for:



- any playing of recorded music between 08.00 and 23.00 on any day on premises authorised to sell alcohol for consumption on those premises, provided that the audience does not exceed 500.
  - any playing of recorded music between 08.00 and 23.00 on any day, in a church hall, village hall, community hall, or other similar community premises, that is not licensed by a premises licence to sell alcohol, provided that (a) the audience does not exceed 500, and (b) the organiser gets consent for the performance from a person who is responsible for the premises.
  - any playing of recorded music between 08.00 and 23.00 on any day, at the non-residential premises of (i) a local authority, or (ii) a school, or (iii) a hospital, provided that (a) the audience does not exceed 500, and (b) the organiser gets consent for the performance on the relevant premises from: (i) the local authority concerned, or (ii) the school proprietor or (iii) the health care provider for the hospital.
  - Dance: no licence is required for performances between 08.00 and 23.00 on any day, provided that the audience does not exceed 500. However, a performance which amounts to adult entertainment remains licensable.
  - Cross activity exemptions: no licence is required between 08.00 and 23.00 on any day, with no limit on audience size for:
    - any entertainment taking place on the premises of the local authority where the entertainment is provided by or on behalf of the local authority;
    - any entertainment taking place on the hospital premises of the health care provider where the entertainment is provided by or on behalf of the health care provider;
    - any entertainment taking place on the premises of the school where the entertainment is provided by or on behalf of the school proprietor; and
    - any entertainment (excluding films and a boxing or wrestling entertainment) taking place at a travelling circus, provided that (a) it takes place within a moveable structure that accommodates the audience, and (b) that the travelling circus has not been located on the same site for more than 28 consecutive days.
3. Where taking place in a building or other structure please tick as appropriate (indoors may include a tent).
  4. For example the type of activity to be authorised, if not already stated, and give relevant further details, for example (but not exclusively) whether or not music will be amplified or unamplified.
  5. For example (but not exclusively), where the activity will occur on additional days during the summer months.
  6. For example (but not exclusively), where you wish the activity to go on longer on a particular day e.g. Christmas Eve.
  7. Please give timings in 24 hour clock (e.g. 16.00) and only give details for the days of the week when you intend the premises to be used for the activity.
  8. If you wish people to be able to consume alcohol on the premises, please tick 'on the premises'. If you wish people to be able to purchase alcohol to consume away from the premises, please tick 'off the premises'. If you wish people to be able to do both, please tick 'both'.

9. Please give information about anything intended to occur at the premises or ancillary to the use of the premises which may give rise to concern in respect of children, regardless of whether you intend children to have access to the premises, for example (but not exclusively) nudity or semi-nudity, films for restricted age groups or the presence of gaming machines.
10. Please list here steps you will take to promote all four licensing objectives together.
11. The application form must be signed.
12. An applicant's agent (for example solicitor) may sign the form on their behalf provided that they have actual authority to do so.
13. Where there is more than one applicant, each of the applicants or their respective agent must sign the application form.
14. This is the address which we shall use to correspond with you about this application.
15. Entitlement to work/immigration status for individual applicants and applications from partnerships which are not limited liability partnerships:

A licence may not be issued to an individual or an individual in a partnership which is not a limited liability partnership who is resident in the UK who:

- does not have the right to live and work in the UK; or
- is subject to a condition preventing him or her from doing work relating to the carrying on of a licensable activity.

Any licence issued in respect of an application made on or after 6 April 2017 will become invalid if the holder ceases to be entitled to work in the UK.

Applicants must demonstrate that they have the right to work in the UK and are not subject to a condition preventing them from doing work relating to the carrying on of a licensable activity.

They do this in one of two ways:

- 1) by providing with this application, copies or scanned copies of the documents which an applicant has provided, to demonstrate their entitlement to work in the UK (which do not need to be certified) as per information published on gov.uk and in guidance.
- 2) by providing their 'share code' to enable the licensing authority to carry out a check using the Home Office online right to work checking service (see below).

#### **Home Office online right to work checking service.**

As an alternative to providing a copy of original documents, applicants may demonstrate their right to work by allowing the licensing authority to carry out a check with the Home Office online right to work checking service.

To demonstrate their right to work via the Home Office online right to work checking service, applicants should include in this application their share code (provided to them upon accessing the service at <https://www.gov.uk/prove-right-to-work>) which, along with the applicant's date of birth, will allow the licensing authority to carry out the check.

In order to establish the applicant's right to work, the check will need to indicate that the applicant is allowed to work in the United Kingdom and is not

subject to a condition preventing them from doing work relating to the carrying on of a licensable activity.

An online check will not be possible in all circumstances because not all applicants will have an immigration status that can be shared digitally. The Home Office online right to work checking service sets out what information and/or documentation applicants will need in order to access the service. Applicants who are unable to obtain a share code from the service should submit copies of documents as set out above.

Your right to work will be checked as part of your licensing application and this could involve us checking your immigration status with the Home Office. We may otherwise share information with the Home Office. Your licence application will not be determined until you have complied with this guidance.

This page is intentionally left blank

Appendix II

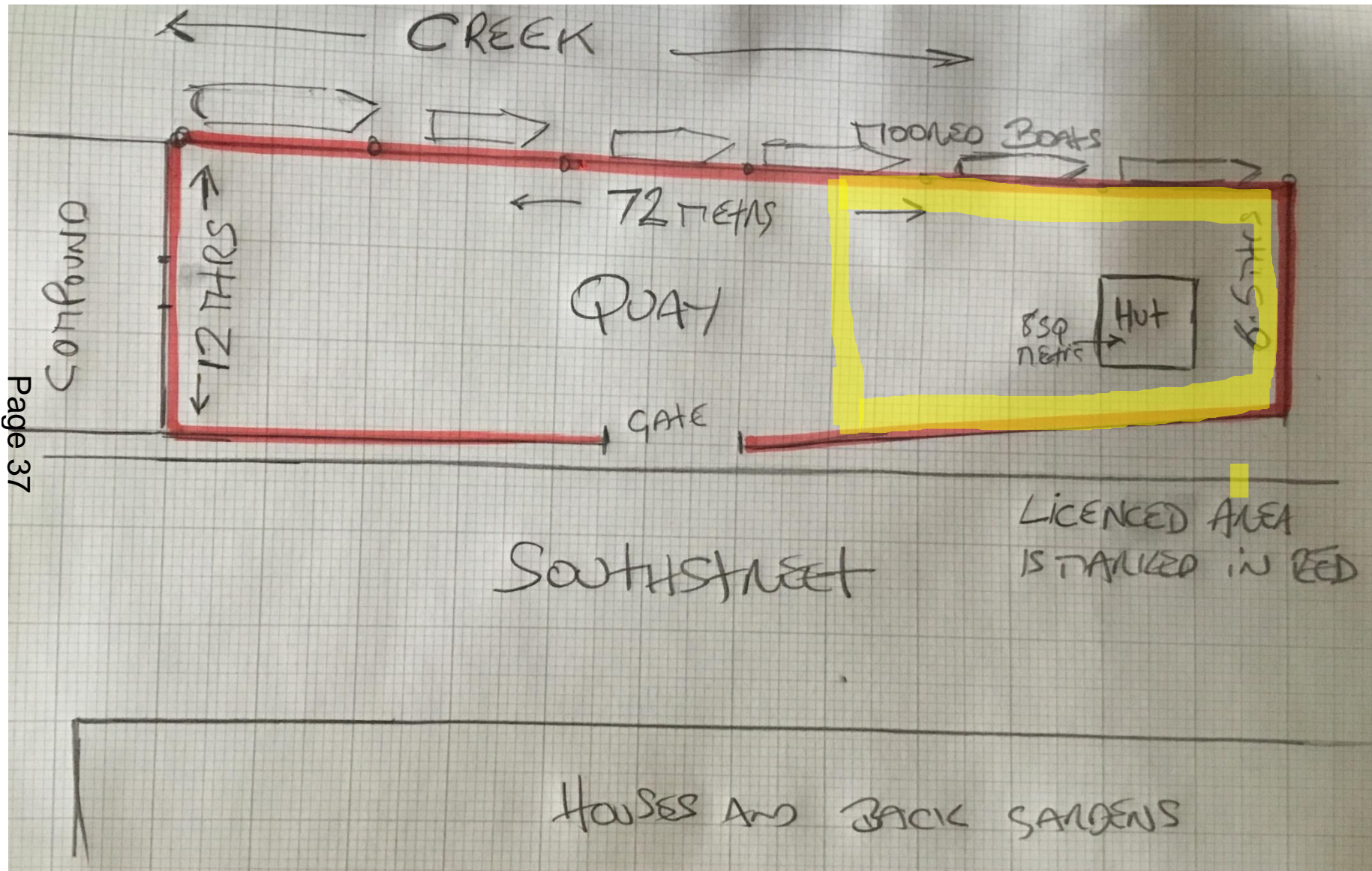

This page is intentionally left blank



This page is intentionally left blank



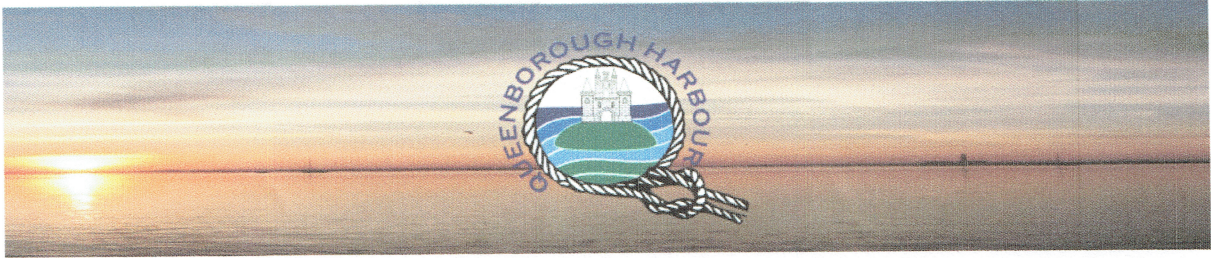

Thursday 28<sup>th</sup> July 2022

Caroline Kennedy  
19 High Street  
Queenborough  
Kent  
ME11 5AA

To whom it may concern,

**R.E. Trawlerman's Catch Queenborough**

Further to recent discussions and meetings regarding the above, we, the directors of Queenborough Harbour Trust, give permission for Caroline Kennedy of Trawlerman's Catch to apply for Alcohol Licensing at their blue hut on South Street, Queenborough.

The license will cover the whole area consisting of the Town Harbour Quay & car parking area.

This letter is **without prejudice and subject to contract**.

Thank you and kind regards,

*For and on behalf of Queenborough Harbour Trust*

**Ian Bone**  
Director

This page is intentionally left blank

**Subject:** RE: License application - Little Blue Hut, Queenborough Harbour

**From:**  
**Sent:** 29 August 2022 16:18  
**To:** Licensing (SBC) <Licensing@swale.gov.uk>  
**Subject:** License application - Little Blue Hut, Queenborough Harbour

**CAUTION: This email originated from outside of the organisation. Do not click links or open attachments unless you recognize the sender and know the content is safe.**

We would like to object to the licence application in respect of the "Little Blue Hut", at Queenborough Harbour, South Street Queenborough.

There are several reasons for this objection and these are set out below.

The behaviour to date of the licensees - These premises used to be a small hut selling fish run by the local fishermen. It had only been there for a couple of years but was quiet and unobtrusive. The hut is not a permanent structure and has no water or drainage, and the electricity supply is a makeshift cable laid across the harbour connected to a 16A marine supply. In June this was taken over by a local pub landlord and suddenly became a real problem. Chairs all over the quay and drunken people abusing residents particularly those swimming and doing watersports. The biggest problem was that actually the premises was not licensed and it was open every Friday, Saturday and Sunday throughout June, July and August. Apparently they were relying on the licence of the pub but this should not have allowed them to open for 13 weeks 3 times a week totalling 39 occasions. They have told us they fully intend to continue opening on these days until they get a permanent licence, and they continue to advertise this on billboards in South Street. So they clearly have absolutely no respect for the licensing laws or the licensing authority. They have though provided an opportunity for local residents to see exactly what it would be like if they were open permanently.

ASB-this is an area with very significant antisocial behaviour and this really only started in June when these premises became licensed. The police have to patrol every weekend because of groups of young people congregating on the quay, smoking and drinking, damaging fishermen's properties and boats. The last thing this area needs is this licensed premises which has no indoor space and simply encourages people to sit around on the quay drinking and adding to, if not causing, the problems for the local residents and the police.

Noise-these premises have no indoor space so all of the people drinking and all of the music would be outdoors. They are just a few metres from residential properties and this would cause (and is already causing) significant noise nuisance for those residents most of whom have their small gardens at the back of the properties directly opposite the fisherman's hut. They can no longer sit in their little gardens on a weekend afternoon because of the noise.

Safety-this small hut is on the edge of the quay literally 2 m from the edge. There are no barriers along the edge of the quay and the water is very deep. There is a significant drop into the water and this is the last place that you want to have people who are drinking alcohol. Also they are already making it dangerous for people walking along the edge of the quay because they are making the walkway so narrow because they have so many tables and chairs. It is impossible to walk safely along the quay and people are forced to walk in the road which is dangerous in itself. Added to this there is a lot of fisherman's equipment in this area because it is right by where the fishing boats leave from. Having people drinking, music and so on right by all the fishing equipment would itself be an added danger.

Queenborough quay used to be a quiet place for people to sit and contemplate the harbour. This year it has become a magnet for ASB and for people sitting on tables and chairs all over the place drinking alcohol and on occasions having musical entertainment. This is completely inappropriate for this area, it is adding to the ASB and it is already causing safety issues for people using the hut but also local residents who just want to walk along the harbour/quay. This is the last place that we want licensed premises and there are plenty of pubs in Queenborough for people to go to and we do not want an outdoor pub in the middle of a residential area on the edge of deep water.



**Subject:** RE: South Street application for extended license

**From:**

**Sent:** 12 August 2022 17:54

**To:** Licensing (SBC) <Licensing@swale.gov.uk>

**Subject:** South Street application for extended license

**CAUTION: This email originated from outside of the organisation. Do not click links or open attachments unless you recognize the sender and know the content is safe.**

I have been trying to establish how to object to an extension of an alcohol license namely at the fresh fish shed on the quay at Queenborough creek, can you advise how I can do this as I am unable to locate this on the SBC webpage.

If time is running out please note my objections as the proposed bar is close to the water which inhibits walking and therefore a danger to those using the area and walking by. Queenborough is a marine conservation area and the extension would cause more disruption to wildlife particularly the seal family who go into this creek area. The noise would disrupt local homes and local water users, People drinking so close to the water could be in danger as there is not adequate guards to the deep drip into the creek and this cannot be blocked as would inhibit local water users and fishermen accessing their boats. There are no toilet facilities so there is the potential for urination in alleys etc. There is very little room where this shed is located and so would block access for users (as it does now but only some days) and the blocking would mean reducing the walk way and therefore people drinking alcohol would be close to the sea - a dangerous combination.

ME11 5AA



## Chris Hills

---

**Sent:** 08 September 2022 12:43  
**Subject:** RE: Consultation - Little Blue Hut - Queenborough

-----Original Message-----

From:  
Sent: 12 August 2022 10:56  
To: Licensing (SBC) <Licensing@swale.gov.uk>  
Subject: Consultation - Little Blue Hut - Queenborough

CAUTION: This email originated from outside of the organisation. Do not click links or open attachments unless you recognize the sender and know the content is safe.

I am a resident of High Street Queenborough.

Although it is encouraging that new businesses are establishing in Queenborough (for example the Bosuns), the current trend, exacerbated by covid has been for our three pubs to extend their business outside and play loud music, often for hours up to 11pm.

This trend has made life for residents miserable. The Rose in particular is now encouraging private parties with music in the evenings. We are in a conservation area and even if we could shut our windows in this hot weather, the noise is still like having a disco right outside as we cannot have double glazing on our property.

Coupled with the direct problem of noise is the lack of parking space and noise of people leaving events.

In conclusion, I would like to object to any music license and have close supervision of alcohol sales if approved. It is one thing to be able to supply a drink with food but another to encourage excessive alcohol use.

Whilst writing, could you please let me know if there is any provision for tempering the current music licenses in Queenborough and also where I am able to see new applications on your website as they arise.

Thank you.





**Subject:** RE: Little-Blue-Hut Queenborough

-----Original Message-----

From:  
Sent: 15 August 2022 15:17  
To: Licensing (SBC) <Licensing@swale.gov.uk>  
Cc:  
Subject: Little-Blue-Hut Queenborough

CAUTION: This email originated from outside of the organisation. Do not click links or open attachments unless you recognize the sender and know the content is safe.

Dear Council

I am writing with regard to the application for licencing of the Little Blue Hut that is at Queenborough Quay.

I appose this vigorously!!

For the reasons below:

We have a number of establishments selling alcohol in the area, namely Queen Phillipa, The Rose, Flying Dutchman, Admirals Walk Micro pub, Yacht Club and Old House at home. All are playing music loudly and all are in and around the high street in Queenborough. We have 6 and do not need another place that sells alcohol that plays loud music!

This hut is right next to the creek, there is no running water for hygiene purposes, no bins that I can see ~ (I saw a man who was standing there drinking and threw his cigarette butt into the creek). We do not need people throwing their rubbish in the water. We have seals that swim up the creek from time to time and residents should not have to put up with pollution from rubbish being dumped into the creek. This is a marine conservation area as well as conservation and residential area.

We do not need music blaring out from here as well as the other pubs.

There are also no toilet facilities so where are people supposed to relieve themselves? In the creek, at the back of the houses, up the alley, on the fisherman's gear, in the boats that are moored against the walls? Where are customers supposed to wash their hands?

Where are the staff supposed to wash their hands as there is no running water? This is also a hygiene/cross contamination issue!

This hut and the tables they put out are hazardous and block the walkway. The tables are right next to the creek and there is only a chain at the edge of the wall.

Where is all the alcohol going to be stored? This hut is only tiny.

Please take my objections on board

Thank you for your time.



**Subject:** RE: Fishing hut South Street Queenborough

**From:**  
**Sent:** 30 August 2022 09:51  
**To:** Licensing (SBC) <Licensing@swale.gov.uk>  
**Subject:** Fishing hut South Street Queenborough

**CAUTION: This email originated from outside of the organisation. Do not click links or open attachments unless you recognize the sender and know the content is safe.**

Dear Licensing Team

I would like some information in relation to the blue fishing hut which is in South Street in Queenborough. This used to just sell fish from the fishermen but since June has been taken over by a couple of local pubs and has been selling alcohol on Fridays, Saturdays and Sundays. I understand that it does not have a permanent alcohol licence but nonetheless has been open for almost 3 months 3 days a week selling alcohol. This is almost 40 occasions and I do not understand how they can do this without having an alcohol licence? If they are relying on the licence from the other pubs how can this extend to 40 occasions? The behaviour of the people using these premises has been awful and they have caused a lot of litter and disruption. Lots of the litter ends up in the creek which just adds to the pollution. They should not be selling alcohol at this location because it is inappropriate and not safe and I would certainly object to any kind of licence at this location. I would really like to know how they can do this without a licence.  
Many thanks



**Subject:** RE: application for the grant of a alcohol license for the premises little blue hut, queenborough harbour / creek

**From:**

**Sent:** 31 August 2022 16:17

**To:** Licensing (SBC) <Licensing@swale.gov.uk>

**Subject:** application for the grant of a alcohol license for the premises little blue hut, queenborough harbour / creek

**CAUTION: This email originated from outside of the organisation. Do not click links or open attachments unless you recognize the sender and know the content is safe.**

good afternoon Licensing dept,

I wish to object to the issue of an alcohol license being issued to the above premises based on the following issues:-

- 1) It is temporary building / hut selling fresh fish and seafood that is mainly selling to the public to take away for their consumption, that is on the public harbour where families are able to walk, sit etc similar to sheerness promenade where the drinking of alcohol had to be stopped as it was deemed incorrect / anti social behaviour, also the building doesn't own any private land to be used for the consumption of any alcohol .
- 2) should anyone require an alcoholic drink there are already 5 licensed premises selling alcohol all within 100 metres of this Hut , all with beer gardens and views over the sea and the queenborough creek.
- 3) if a licence is issued will customers be able to just purchase just alcohol without purchasing any fish or seafood etc, because if so that means its trying to skip round normal public house requirements / regulations toilets etc which will be needed.
- 4) for the all the reasons mentioned above this area which is at present a nice place for people to sit & walk and enjoy a peaceful time this will cease as they will put off having people standing and sitting on seats they are putting out just for drinking ( which I assume they have permission & insurance etc to do this) on the public highway as the majority of the public don't visit the harbour to purchase fish or alcohol.

island resident



**Subject:**

RE: New Premises Licence - Little Blue Hut Queenborough Harbour South Street  
Queenborough ME11 5AF

**From:**

**Sent:** 11 September 2022 21:34

**To:** Licensing (SBC) <Licensing@swale.gov.uk>; Stephanie Curtis <StephanieCurtis@swale.gov.uk>

**Subject:** Fw: New Premises Licence - Little Blue Hut Queenborough Harbour South Street Queenborough ME11 5AF

I am just resending my objections to the blue hut which still stand

As I said in a previous email, the same licensee had a noise complaint on Saturday night(10th) with music going on to well past 11:45pm and while people are grieving over the loss of our monarch .

safety issues the tables have now spread meaning to get walk along the quay people pass dangerously close to waters edge, with a 4m+ drop when the tide is out.

Plastic utensils pots etc. are finding there way into the creek, no waste disposal system a lot of the time they are using the public bins for commercial waste No toilet facilities or running water, people urinating in the alleys this week again.

Anti-social behaviour is on the rise in Queenborough and as you well know, with the creek area being a hot spot, do we really need to fuel this with even more alcohol. We only had to listen to the residents at the public meeting to see that. Even today people where walking up and down south street with pints of beer, which was not acceptable.

24 hours after the queen, died loud music from the Dutchman again this was reported to noise enforcement, I know that you will say this allowed but sorry there is no respect for the residents, and how do we know the blue hut will not go the same way, as it is how's has been operating for the past months selling alcohol?

As I have said time and time again, we need to consider the people that live here, not hide behind bureaucracy there must be things that can be done rather than running roughshod over the residents who pay our salaries and who rightly expect us look after their interests, they have no voice and rely on us for common sense to prevail.

Our lack of control/concern means many residents now live with windows shut, unable to use their gardens, and they have been told by publicans you should not live next to a pub!!!, they have to put with drunks, vile language, vomit, people urinating against their walls, criminal damage, so much so that I know at least 3 families that are moving out of the area.

To that end we have failed in our duty to look after them, and we all need to look at how we have let them down, and I feel extremely sad that this has happened, and take it as a call to action.

There are meetings now being discussed to set up an action group against the way people are being treated by the public houses with a campaign to highlight the lack of action by councillor's and I include me in that category for turning a blind eye in the past, and SWBC

---

**From:**

**Sent:** Tuesday, August 9, 2022 8:35 PM

**To:** Licensing (SBC) <[Licensing@swale.gov.uk](mailto:Licensing@swale.gov.uk)>;

**Subject:** Re: New Premises Licence - Little Blue Hut Queenborough Harbour South Street Queenborough ME11 5AF  
My initial thoughts, i will write again, but I must object in the strongest terms.

Thank you for your email somewhat surprising considering the trouble we are having in this area anyway with alcohol.

The quay is an area where people walk with their children and enjoy looking at the boats and sitting watching the world go by. The last thing we want is lots of alcohol consumption and the area becoming a no-go area like the causeway, then off limits to the general public.

Surely the area in question is for all people to use , once a license is granted the area will be full of seating and destroy the ambience of the historic harbor.

Does this then mean the temporary timber shed that was put up for the seasonal markets will become a permanent structure, then will it not need planning permission?

The applicant runs the dutchman why do we need music right next to everyone's back gardens when music is played at the other venue and also at the Rose across the road, phillipa around the corner and the old house at home at the opposing end

I must insist that you write/contact all the houses that back onto South Street and those within South Street as I know no one that will welcome this proposal at all.

*Prevention of crime and disorder.* The antisocial behavior from people drinking in public areas is a real problem now

*Prevention of public nuisance* it is a public space backing onto people's gardens. Why should they have live music and drink forced upon them from what is effectively public realm. Where will the toilet facilities be, as drunks already urinate against peoples walls and down the alleys.

*Protection of public safety* right next to the water



**From:** Licensing (SBC)

**From:**

**Sent:** 11 September 2022 18:28

**To:** Licensing (SBC) <Licensing@swale.gov.uk>

**Subject:** Comment on Market Place's Premises Licence Application

Hello

I am writing to object to the licence application of the Little Blue Hut at the Queenborough Creek, South Street. I wasn't going to bother writing to you as I know that the license will be given regardless of objections. I was also not sure that highlighting our current issues that we already have in Queenborough with the public house situation (the noise, loud music that goes on way after 10pm, brutal fights, issues parking etc.), although we cannot escape them as residents, are not wholly the Flying Dutchman's doing. Caroline also wanted to reassure me that the music and drinking at the little blue hut would be kept low key. However, upon thinking further about the safety of the people drinking there and the surrounding dangers that present themselves for anyone under the influence of alcohol, I don't think it is a suitable venue. I know it can be argued that there are public houses dotted all over Queenborough and the risk is still there but having the hut so close to the creek simply puts potential dangers closer. People could either drown in the water, fall on the concrete berths, or get stuck in the mud on a fast tide.

I also wondered where the patrons would go if they needed to relieve themselves – as often people do if they've had a drink of alcohol – and Caroline assured me that they could go to the Flying Dutchman toilets. The Flying Dutchman is quite a walk from the little blue hut (about 3 minutes) with an alley between houses to access the High Street where the pub is located. I believe that some males will be tempted to relieve themselves in the alley or in the creek instead of walking three minutes to go to the loo (which could cause issues with children potentially seeing this behaviour – in terms of safeguarding and thinking it is acceptable behaviour). There will also be disturbance to residents on the high street with people walking between the Dutchman and the little blue hut to use the toilets. I also worry about the amount of litter and cigarette ends which may end in the creek from this venture. But I suppose licencing don't need to have any consideration for this or any other consequences of having yet another drinking establishment in Queenborough.

I appreciate that someone wants to branch out and increase their profits, build their business etc. but having heard the loud music last night that went on until 23:15 at the Flying Dutchman for a wedding – it reminded me that there seems to be little respect for the neighbouring residents if this gets in the way of making profit. We seem to be stuck between five public houses, some wanting to play loud music until late, some where people are drinking outside making noise, littering the beach with either glass or plastic, and we cannot escape the noise. So, I feel like I'm given no

choice than to voice my opinion and raise my concerns knowing that they will be discarded on the pile of other correspondence of concern.

The latest announcement on social media that the Flying Dutchman will be offering themselves as a wedding venue fills me with dread if last night is anything to go by. I was under the impression that the Aviator was becoming a wedding venue, making good sense because there is ample parking and no neighbours to consider.

I feel I've still wasted half an hour of my life writing this in vain.

Best wishes